

REGUPOL® SONUSWAVE

Acoustic Floor Detail

Unroll Regupol SonusWave 8 making sure that dimple side faces down. Make sure that the SonusWave is installed tightly against each other. Install the 4" isolation rubber around all walls & obstacles that penetrate the floor. Install 4mil poly vapor barrier on top of the SonusWave and run up the wall. Use tape to hold the poly up the wall. Use tape to hold the poly on the walls and use tape if the poly needs overlapping. Pour concrete on top needs overlapping. Pour concrete on top of the poly film. Cut excess rubber & poly film flush to top of newly poured slab.

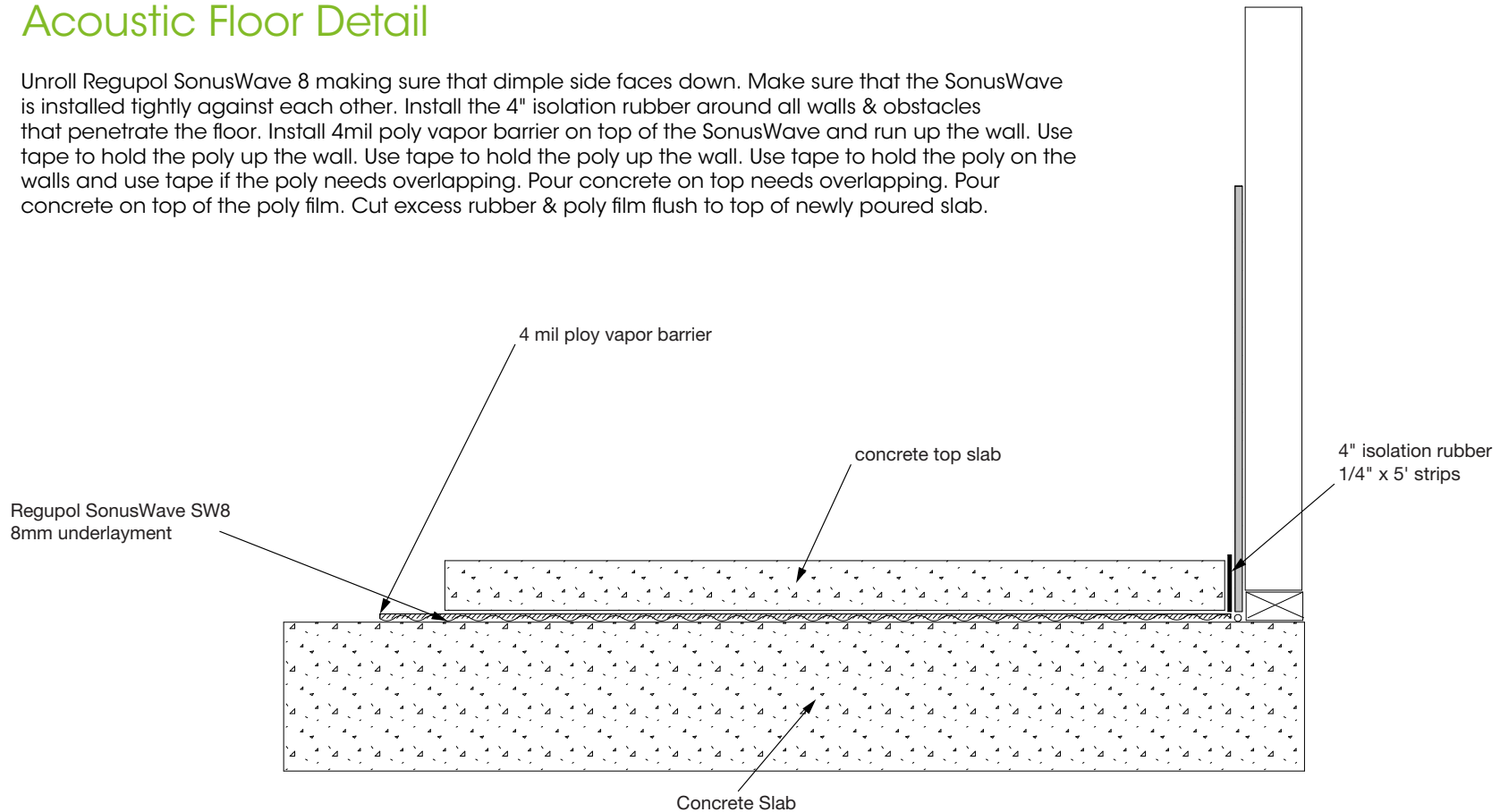

Project Name: Product Detail

Scale: Not to Scale

Part / Drawing number: 102814